

REVISIONS				
REV	ECN #	DESCRIPTION	REV. BY/DATE	APR. BY
A	-----	REDRAWN & UPDATED IN SOLIDWORKS	06/1998	

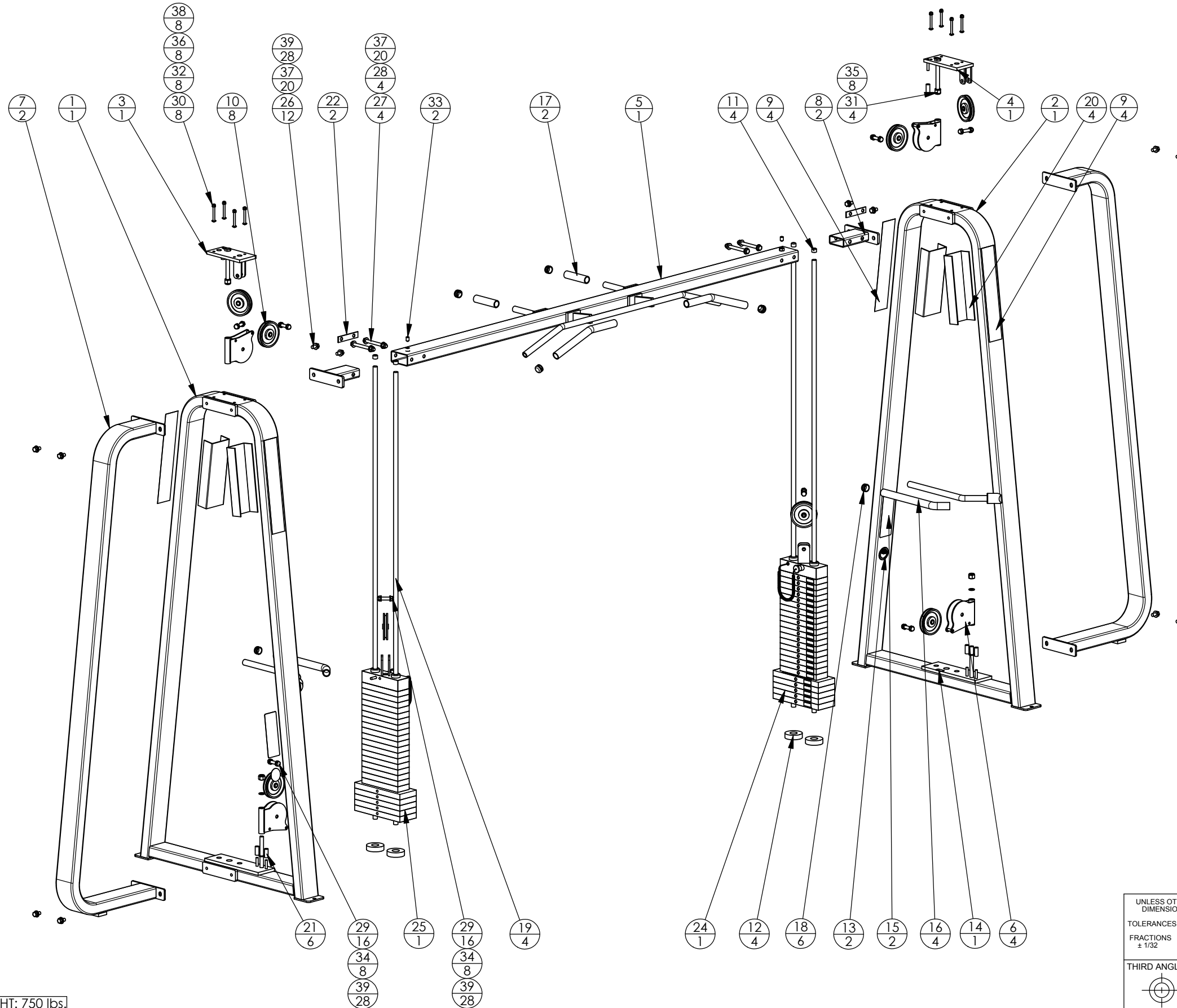

ITEM NO.	QTY.	PART NO.	DESCRIPTION
1	1	SA1010-8-R	FIXED HI-LO RIGHT 'A' FRAME ASSY
2	1	SA1010-8-L	FIXED HI-LO LEFT 'A' FRAME ASSY
3	1	SA1033-1	RIGHT TOP PLATE ASSY
4	1	SA1033-2	LEFT TOP PLATE ASSY
5	1	SA1034-1	CROSSBEAM ASSY #1
6	4	SA1035	SWIVEL PULLEY HOUSING ASSY
7	2	SA1078-1	FLANGED 'C' FRAME ASSY, W/O BRACKETS
8	2	SA1511	FIXED HI-LOW ADAPTER BKT. #2
9	4	AC1002	LABEL, "ICARIAN", 3 1/2 x 21 1/2
10	8	AC1009	PULLEY, 4 1/2" DIA x 1/2" ID
11	4	AC1040	CAP, GUIDE ROD, DIA. 3/4
12	4	AC1148	WEIGHT STACK BUMPER
13	2	AC1161	LABEL, ROUND, "MADE IN USA"
14	1	AC1164	LABEL, F.P.I. SERIAL NUMBER
15	2	AC1183	LABEL, "WARNING, SERIOUS INJURY..."
16	4	AC1226-15	RUBBERGRIP, DIA 1 x (15)
17	2	AC1226-6	RUBBERGRIP, DIA 1 x (5)
18	6	AC218	HANDLE END CAP W/SET SCREWS, DIA 1"
19	4	CH1218	STEEL BAR RND, DIA. 3/4" x (80 3/4), #8
20	4	CP1081	CUT PIECE, ABS CHANNEL, 1/8 x 2 x 4 1/4 x 12
21	6	CP1165	VINYL HOSE, 5/8 OD x 3/8 ID x (1 1/2)
22	2	CP1190	ABS BLACK, 1/8 x 1 x 4 3/4, 2 HOLES
23	2	II-407-205-000	CABLE ASSY, II-407-205-000
24	1	WS1503	WEIGHT STACK, 24 PLATE, 150 LBS.
25	1	WS1504	WEIGHT STACK, 24 PLATE, 150 LBS.
26	12	FA1011	BOLT, HEX HEAD, BLK, 1/2-13 x 1
27	4	FA1020	BOLT, HEX HEAD, BLK, 1/2-13 x 5
28	4	FA1030	NUT, HEX, NYLOCK, 1/2-13
29	16	FA1035	NUT, HEX, ACORN, 1/2-13
30	8	FA1037	NUT, HEX, 5/16-18
31	4	FA1045	NUT, HEX, NYLOCK, 5/8-11
32	8	FA1074	BOLT, BUTTON HEAD, 5/16-18 x 3
33	2	FA1087	SCREW, SET, SCKT, CUP POINT, 1/2-13 x 3/4
34	8	FA1101	STUD, 1/2-13 x 2 1/2
35	8	FA1102	WASHER, NYLON, 5/8 ID x 15/16 OD x 3/32
36	8	FA1106	WASHER, FLAT, 5/16 ID x 11/16 OD
37	20	FA1109	WASHER, FLAT, 1/2 ID x 1 1/16 OD
38	8	FA1116	WASHER, SPLIT, 5/16 ID
39	28	FA1119	WASHER, SPLIT, 1/2 ID

WEIGHT: 750 lbs.

UNLESS OTHERWISE SPECIFIED DIMENSIONS ARE IN INCHES

TOLERANCES ARE:  
 FRACTIONS ± 1/32    DECIMALS .XX ± .01    ANGLES ± 1°  
 .XXX ± .005

THIRD ANGLE PROJECTION

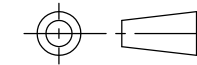

DO NOT SCALE DRAWING



**FITNESS PRODUCTS INTERNATIONAL**  
 ICARIAN FLITE ABENCH JADE STRETCH CENTER  
 12660 BRANFORD ST. SUN VALLEY, CA. 91352

APPROVALS	DATE	TITLE
DESIGNED BY AA	06/97	FIXED CABLE CROSSOVER
MODELED BY JCM	06/98	
DRAWN BY RJB	04/00	
APPROVED BY		SIZE B

DWG. NO.	407-EXP
----------	---------

SCALE	1:18
SHEET	1 OF 1
REV	A

**407 Fixed Cable Crossover**

<b>Part Number</b>	<b>Description</b>	<b>Bubble Number</b>
CWHCYN050-500	SCREW, HEX HEAD, BLK XYLAN, 1/2-13	32
CWWBKN050-010	WASHER, FLAT, TYPE A, SAE, 1/2 ID X	37
CWHCYN050-100	SCREW,HEX HEAD,BLK XYLAN,1/2-13 X 1	39
CWKDYN050-059	LOCKNUT, NYLON INSERT, FULL, UNC, 1	41
CWKADLN050-081	NUT, ACORN, 1/2-13	47
CWWBKN050-010	WASHER, FLAT, TYPE A, SAE, 1/2 ID X	48
CWWALYN050-013	WASHER, SPLIT, 1/2 ID, BLK XYLAN	49
CWWALYN050-013	WASHER, SPLIT, 1/2 ID, BLK XYLAN	50
CWBFNN050-250	STUD, 1/2-13 X 2 1/2	51
CWGR2636-000	GRIP,RUBBER, 1" DIA, 36"	57
CW31907-721	WELDMENT, TOP PULLEY HSG PLATE, FIX	90
CWAC1009-101	PULLEY, 4 1/2 DIA. X 1/2 ID	91
CW10340-150	TUBE, VINYL, 5/8 OD X 3/8 ID X 1.50	92
CW30897-101	HANDLE, WEBBING 22.5", D-RING	114
CWAC4019-101	ACCESSORY, HANDLE , SINGLE D, SOLID	115
CWEANN050-075	SCREW, SET, SCKT, CUP POINT, 1/2-13	117
CW10505-721	ASSY, PLATE, WEIGHT, 05 LBS, WRKL B	200
CW10510-721	ASSY, PLATE, WEIGHT, 10 LBS, WRKL B	201
CWAC1133-101	BUSHING, WEIGHT PLATE, LDPE PLASTIC	203
CW30172-751	ASSY, 4.00 IN WEIGHT STACK PIN AND	227
CWLDNN038-200	PIN, ROLL, DIA 3/8 X 2	250
CW30184-901	ASSY,BARREL, TOP PLATE,ALUMINUM	251
CW30386-721	WELDMENT, WEIGHT, TOP, STP-T, PF118	253
CW30387-721	WELDMENT, WEIGHT, TOP, STP-T, PF118	254
CW30133-712	SELECTOR STEM, 25 PLATE,0 .875 DIA,	310
CWAC1185-101	LABEL,KEEP HND&FT CLR(CEMCO)3/8X6.75	312
CW12401-101	LABEL, WEIGHT PLATE, 7.5 LBS/ 3.5 K	314
CW12401-102	LABEL, WEIGHT PLATE, 10 LBS/ 4.6 KG	315
CW12401-103	LABEL, WEIGHT PLATE, 12.5 LBS/ 5.7	316
CW12401-104	LABEL, WEIGHT PLATE, 15 LBS/ 6.8 KG	317
CW12401-105	LABEL, WEIGHT PLATE, 17.5 LBS/ 8 KG	318
CW12401-106	LABEL, WEIGHT PLATE, 20 LBS/ 8 KG	319
CW12401-107	LABEL, WEIGHT PLATE, 22.5 LBS/ 10.2	320
CW12401-108	LABEL, WEIGHT PLATE, 25 LBS/ 11.4 K	321
CW12401-109	LABEL, WEIGHT PLATE, 27.5 LBS/ 12.5	322
CW12401-110	LABEL, WEIGHT PLATE, 30 LBS/ 13.6 K	323
CW12401-111	LABEL, WEIGHT PLATE, 32.5 LBS/ 14.8	324
CW12401-112	LABEL, WEIGHT PLATE, 35 LBS/ 15.9 K	325
CW12401-113	LABEL, WEIGHT PLATE, 37.5 LBS/ 17 K	326
CW12401-114	LABEL, WEIGHT PLATE, 40 LBS/ 18.2 K	327
CW12401-115	LABEL, WEIGHT PLATE, 42.5 LBS/ 19.3	328
CW12401-116	LABEL, WEIGHT PLATE, 45 LBS/ 20.5 K	329
CW12401-117	LABEL, WEIGHT PLATE, 47.5 LBS/ 21.6	330
CW12401-118	LABEL, WEIGHT PLATE, 50 LBS/ 22.7 K	331
CW12401-119	LABEL, WEIGHT PLATE, 55 LBS/ 25 KG	332
CW12401-120	LABEL, WEIGHT PLATE, 60 LBS/ 27.3 K	333
CW12401-121	LABEL, WEIGHT PLATE, 65 LBS/ 29.5 K	334
CW12401-122	LABEL, WEIGHT PLATE, 70 LBS/ 31.8 K	335
CW12401-123	LABEL, WEIGHT PLATE, 75 LBS/ 34.1 K	336

CW12401-124	LABEL, WEIGHT PLATE, 80 LBS/ 36.4 K	337
CW12401-125	LABEL, WEIGHT PLATE, 85 LBS/ 38.6 K	338
CW12401-126	LABEL, WEIGHT PLATE, 90 LBS/ 40.9 K	339
CW12401-127	LABEL, WEIGHT PLATE, 95 LBS/ 43.2 K	340
CW30387-721	WELDMENT, WEIGHT, TOP, STP-T, PF118	354

**407 Fixed Cable Crossover**

<b>Part Number</b>	<b>Description</b>	<b>Bubble Number</b>
CWHCYN050-500	SCREW, HEX HEAD, BLK XYLAN, 1/2-13	32
CWWBKN050-010	WASHER, FLAT, TYPE A, SAE, 1/2 ID X	37
CWHCYN050-100	SCREW, HEX HEAD, BLK XYLAN, 1/2-13 X 1	39
CWKDYN050-059	LOCKNUT, NYLON INSERT, FULL, UNC, 1	41
CWKADLN050-081	NUT, ACORN, 1/2-13	47
CWWBKN050-010	WASHER, FLAT, TYPE A, SAE, 1/2 ID X	48
CWWALYN050-013	WASHER, SPLIT, 1/2 ID, BLK XYLAN	49
CWWALYN050-013	WASHER, SPLIT, 1/2 ID, BLK XYLAN	50
CWBFNN050-250	STUD, 1/2-13 X 2 1/2	51
CWGR2636-000	GRIP, RUBBER, 1" DIA, 36"	57
CW31907-721	WELDMENT, TOP PULLEY HSG PLATE, FIX	90
CWAC1009-101	PULLEY, 4 1/2 DIA. X 1/2 ID	91
CW10340-150	TUBE, VINYL, 5/8 OD X 3/8 ID X 1.50	92
CW30897-101	HANDLE, WEBBING 22.5", D-RING	114
CWAC4019-101	ACCESSORY, HANDLE, SINGLE D, SOLID	115
CWEANN050-075	SCREW, SET, SCKT, CUP POINT, 1/2-13	117
CW10505-721	ASSY, PLATE, WEIGHT, 05 LBS, WRKL B	200
CW10510-721	ASSY, PLATE, WEIGHT, 10 LBS, WRKL B	201
CWAC1133-101	BUSHING, WEIGHT PLATE, LDPE PLASTIC	203
CW30172-751	ASSY, 4.00 IN WEIGHT STACK PIN AND	227
CWLDNN038-200	PIN, ROLL, DIA 3/8 X 2	250
CW30184-901	ASSY, BARREL, TOP PLATE, ALUMINUM	251
CW30386-721	WELDMENT, WEIGHT, TOP, STP-T, PF118	253
CW30387-721	WELDMENT, WEIGHT, TOP, STP-T, PF118	254
CW30133-712	SELECTOR STEM, 25 PLATE, 0 .875 DIA,	310
CWAC1185-101	LABEL, KEEP HND&FT CLR (CEMCO) 3/8 X 6.75	312
CW12401-101	LABEL, WEIGHT PLATE, 7.5 LBS/ 3.5 K	314
CW12401-102	LABEL, WEIGHT PLATE, 10 LBS/ 4.6 KG	315
CW12401-103	LABEL, WEIGHT PLATE, 12.5 LBS/ 5.7	316
CW12401-104	LABEL, WEIGHT PLATE, 15 LBS/ 6.8 KG	317
CW12401-105	LABEL, WEIGHT PLATE, 17.5 LBS/ 8 KG	318
CW12401-106	LABEL, WEIGHT PLATE, 20 LBS/ 8 KG	319
CW12401-107	LABEL, WEIGHT PLATE, 22.5 LBS/ 10.2	320
CW12401-108	LABEL, WEIGHT PLATE, 25 LBS/ 11.4 K	321
CW12401-109	LABEL, WEIGHT PLATE, 27.5 LBS/ 12.5	322
CW12401-110	LABEL, WEIGHT PLATE, 30 LBS/ 13.6 K	323
CW12401-111	LABEL, WEIGHT PLATE, 32.5 LBS/ 14.8	324
CW12401-112	LABEL, WEIGHT PLATE, 35 LBS/ 15.9 K	325
CW12401-113	LABEL, WEIGHT PLATE, 37.5 LBS/ 17 K	326
CW12401-114	LABEL, WEIGHT PLATE, 40 LBS/ 18.2 K	327
CW12401-115	LABEL, WEIGHT PLATE, 42.5 LBS/ 19.3	328
CW12401-116	LABEL, WEIGHT PLATE, 45 LBS/ 20.5 K	329
CW12401-117	LABEL, WEIGHT PLATE, 47.5 LBS/ 21.6	330
CW12401-118	LABEL, WEIGHT PLATE, 50 LBS/ 22.7 K	331
CW12401-119	LABEL, WEIGHT PLATE, 55 LBS/ 25 KG	332
CW12401-120	LABEL, WEIGHT PLATE, 60 LBS/ 27.3 K	333
CW12401-121	LABEL, WEIGHT PLATE, 65 LBS/ 29.5 K	334
CW12401-122	LABEL, WEIGHT PLATE, 70 LBS/ 31.8 K	335
CW12401-123	LABEL, WEIGHT PLATE, 75 LBS/ 34.1 K	336

CW12401-124	LABEL, WEIGHT PLATE, 80 LBS/ 36.4 K	337
CW12401-125	LABEL, WEIGHT PLATE, 85 LBS/ 38.6 K	338
CW12401-126	LABEL, WEIGHT PLATE, 90 LBS/ 40.9 K	339
CW12401-127	LABEL, WEIGHT PLATE, 95 LBS/ 43.2 K	340
CW30387-721	WELDMENT, WEIGHT, TOP, STP-T, PF118	354